

## Package Contents

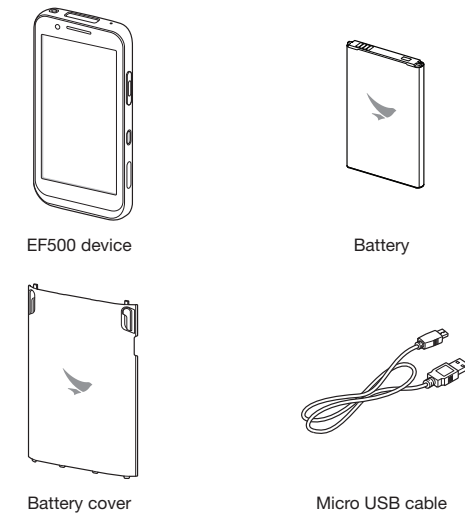

- Both Windows and Android packages include same components as described above.
- The illustrations may differ from your actual items.

## Product Overview

### Front

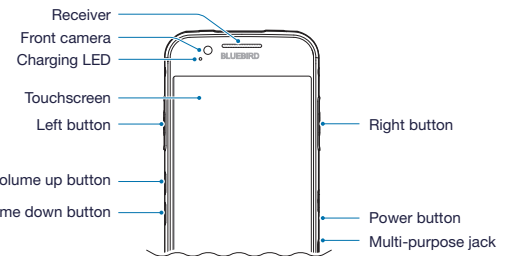

### For Windows

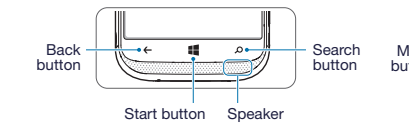

### For Androids

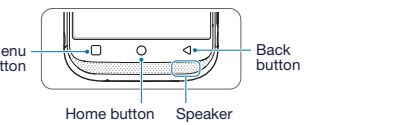

- Windows and Android devices are same except for the touch buttons on the front of the devices.

### Back

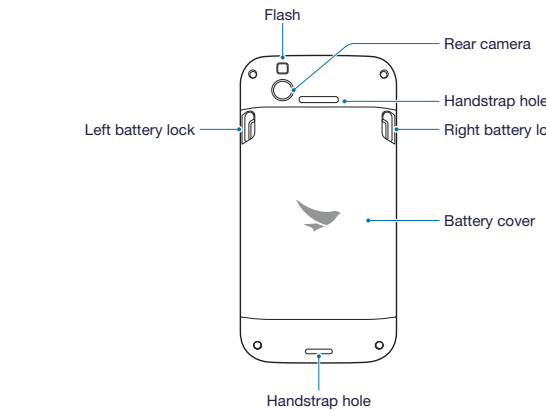

### Bottom and Top

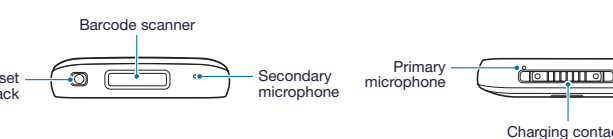

## Inserting the inner components

- Lift up the battery locks to unlock the battery cover.
- Use the notch and lift the battery cover. Remove the cover completely.
- Lift the battery out of the compartment with your fingernail, if necessary.
- Slide the fasteners and lift them up for opening.
- Insert micro SIM cards and a micro SD card into each slot.
- Lift down the fasteners and slide them for locking.
- Slide the SAM card into the slot.
- Insert the battery. Make sure the gold contacts are aligned.
- Insert the bottom of the cover first and then press around the edges of cover.
- Close the battery locks to lock the battery cover.

**Micro SD and SIM cards**

**Battery**

**SAM card**

- If you want to remove the inner components, follow this steps in reverse.
- It will click when it is properly inserted.
- It will click when it is properly inserted.

## Charging the Battery

- Open the cover of multi-purpose jack.
- Plug the micro 5-pin end of the charger into the device's multi-purpose jack.
- Connect the micro USB cable with power adapter and then plug the charger into a power outlet.

- The charging LED turns red when the battery is charging.
- The charging LED turns green when the battery is fully charged.
- You can also charge the device with the optional cradle.

## Turning the Device On or Off

### Turning the Device On

Press and hold the Power button for a few seconds.

### Turning the Device Off

- Press and hold the Power button for a few seconds.
- For Windows device, drag the screen downward. For Android device, tap **Power off**.

- To turn the screen on or off, press the Power button.
- Registering the accounts without turning on the Wi-Fi may incur extra charges depending on your data plan.
- Do not turn off the device by removing the battery, as this may damage the device.



## BLUEBIRD CUSTOMER SERVICE

### Operating Hours

Monday to Friday 9:30 A.M. - 6:30 P.M.  
(GMT Time: +9 Hours)  
The center is closed on Saturdays,  
Sundays, and Korean national holidays.

Bluebird constantly strives to bring utmost satisfaction to all our customers.

### Customers Service Center

Ssang-young IT Twin Tower, B703  
531, Dunchon-daero, Joongwon-gu,  
Seongnam-si, Gyeonggi-do,  
South Korea, 13216

## Using the Touchscreen

Use finger gestures to use the touchscreen effectively.

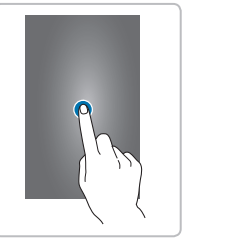

Tap

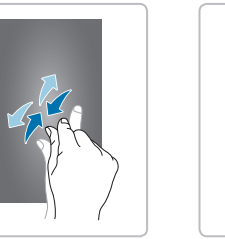

Zoom in or out

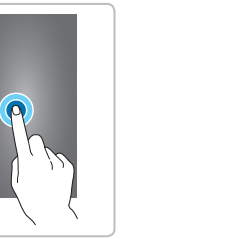

Tap and hold

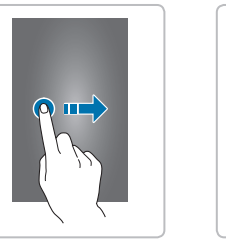

Swipe

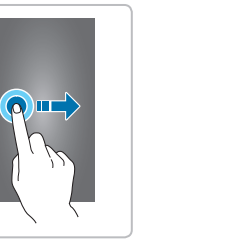

Drag

## Screen Overview

Depending on the operating system of your purchased EF500 device, the initial screen is different. This screen is the starting point for all apps and features.

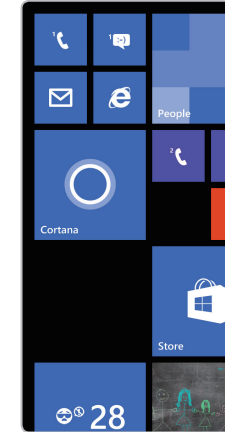

Windows Start Screen

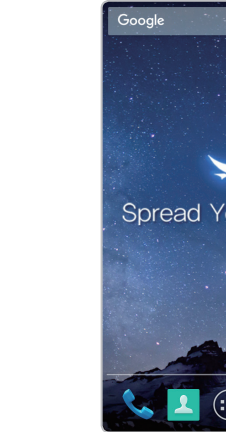

Android Home Screen

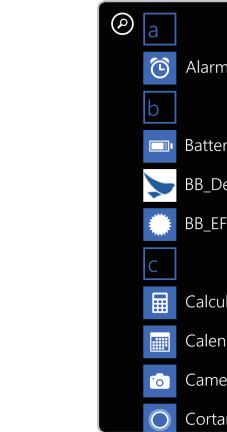

Windows Apps Screen

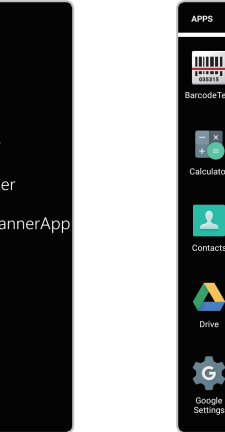

Android Apps Screen

For Windows device, tap **All apps** on the Start screen and for Android device, tap on the Home screen.

Swipe the screen to search for a app you want to open or a feature you want to use.

## Connecting to a Wi-Fi Network

### For Windows

On the Start screen, tap **All apps** > **Settings** > **Wi-Fi**.

Turn on a Wi-Fi networking and tap the network you want to join.

### For Android

On the Home screen, tap > **Wi-Fi**.

Turn on a Wi-Fi networking and tap the network you want to join.



If necessary, enter the password for the network. If you don't know the password, contact the administrator for the network.

## Connecting to a Bluetooth Device

### For Windows

On the Start screen, tap **All apps** > **Settings** > **Bluetooth**.

Turn on a Bluetooth feature and tap the device name you want to pair.

### For Android

On the Home screen tap > **Bluetooth**.

Turn on a Bluetooth feature and tap the device name you want to pair.

## Accessories

### Cradles

- 1-slot charging cradle: One charging slot for a handset, one charging slot for a spare battery, one micro USB port
- 4-slot charging cradle: Four charging slots for handsets, four charging slots for spare batteries, one micro USB port
- 1-slot Ethernet cradle: One charging slot for a handset, one charging slot for a spare battery, one micro USB port, Ethernet port
- 4-slot Ethernet cradle: Four charging slots for handsets, four charging slots for spare batteries, one micro USB port, Ethernet port



The power adapter, AC power plug and AC power cable require the use of charging cradles.

### Batteries/ Battery Covers

- Standard battery: 3,200 mAh
- Extended battery: 6,400 mAh
- Standard battery cover
- Extended battery cover

### Vehicle Accessories

- Vehicle charger
- Vehicle mounting cradle

### Scanning Accessories

- RFID sled

### Carrying Accessories

- Holster
- Handstrap



If you want to purchase a handstrap, please ask a sales representative.

### Other Accessories

- Stylus pen
- Protective film
- Adapter plug (220 V)
- Power adapter for direct charging
- Pistol grip
- User manual
- Quick guide

## More Information

### Warranty Information

Bluebird Inc. (hereinafter referred to as Bluebird) provides the warranty service for its products in compliance with the Bluebird's warranty program.

Upon receiving a notification on a defect of its product within the range of warranty during the warranty period, Bluebird will repair or replace the defective product according to its warranty policy.

If the defective product within the range of warranty is not repairable or replaceable, Bluebird shall refund the purchasing price within a designated period from the date of receiving a notice of defect.

Bluebird assumes no responsibility for repairing, replacement or refund until it receives the defective product from the customer. The replacement shall be equivalent to a new product in the aspect of performance.

This warranty is applied to software products only when the programming commands are not executed. Bluebird does not guarantee interruption-free or error-free performance.

For more warranty information, see the User Manual.

### User Manual

For more details on your device, you can download User Manual from [www.mypidion.com](http://www.mypidion.com). The paper version may be available for some regions.

ENTERPRISE FULLTOUCH HANDHELD COMPUTER

# EF500

QUICK GUIDE

BLUEBIRD

